

Please read this user manual prior to using the machine.



MANUS
espresso machine

USER MANUAL

HX Boiler
Stainless Steel



PUMP Type



ϕ 1.1 / 3 Hole
Steam Tip



58mm
Group Head



*The contents of this user manual is subject to change at any time without notice



El Rocio

MANUS
espresso machine

1. Contents and included accessories
2. Precautions before using
3. Information display
4. How to use
5. Cleaning and maintenance
6. FAQ

Contents and included accessories

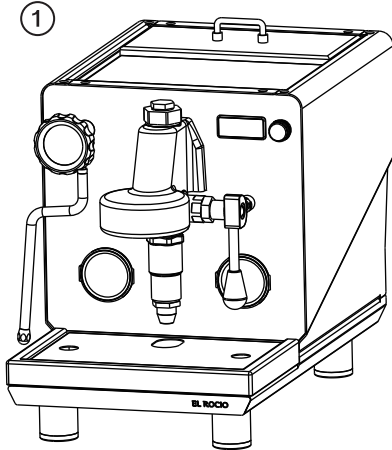

- ① Manus
- ② Double spout portafilter (chrome)
- ③ Blind basket
- ④ Cleaning brush
- ⑤ Single basket
- ⑥ Double basket
- ⑦ User manual
- ⑧ Drain hose

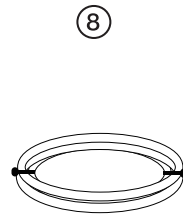
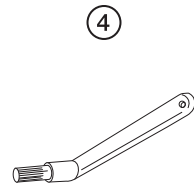
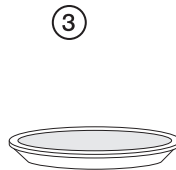
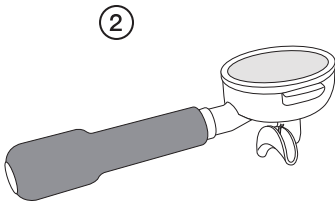

Contents and included accessories

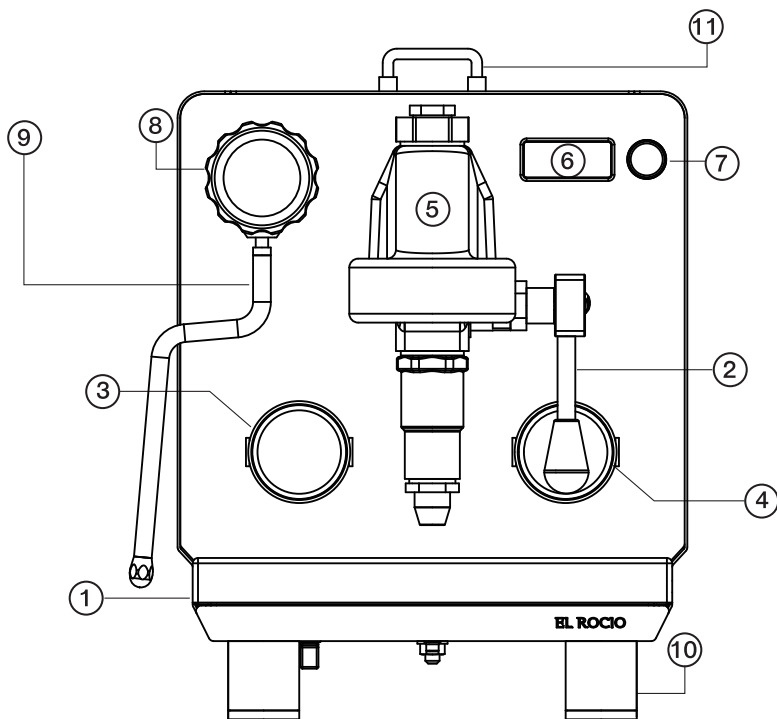

- | | |
|------------------------|--------------------------|
| ① Drip tray | ⑦ Settings dial |
| ② Brew group lever | ⑧ Steam valve |
| ③ Steam pressure gauge | ⑨ Steam wand |
| ④ Brew pressure gauge | ⑩ Machine feet |
| ⑤ Group head | ⑪ Water reservoir handle |
| ⑥ FND Display | |

Contents and included accessories

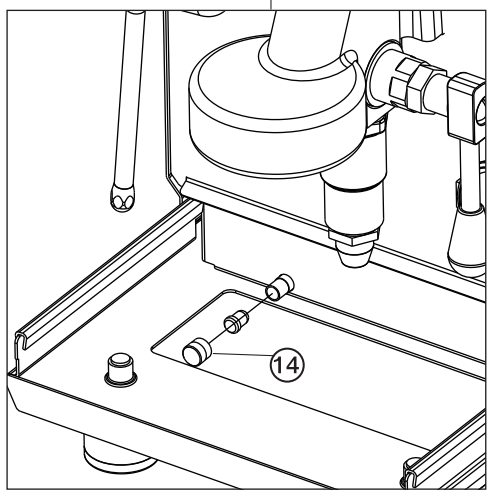
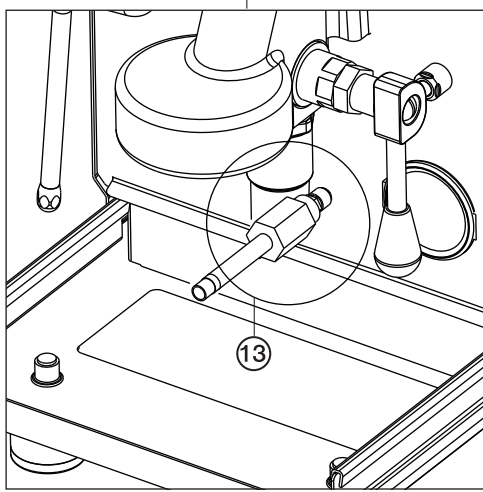
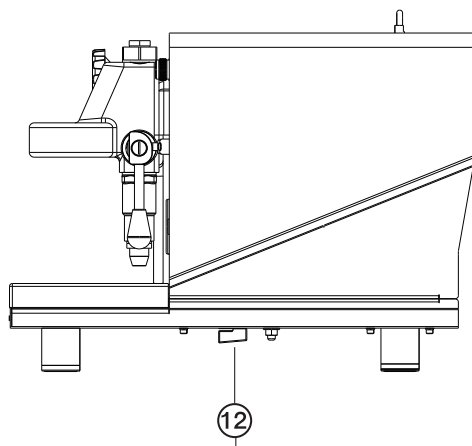

- ⑫ Drain ball valve
- ⑬ Drain pipe
- ⑭ Drain plug

Precautions

Please read carefully before using.

We are not responsible for any safety incidents that may arise from ignoring the safety precautions.



WARNING

This product's electric specification is for Korea: 220V / 60Hz / 1.5Kw.

Please use the correct electric specification.

Ignoring the precautions may lead to physical injuries or damages.

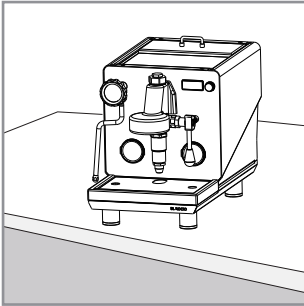

WARNING

(Heavy object)

Product weight approximately 20 ~ 22kg

- Please use caution when installing the machine and use proper form.
- Install/use the machine on a solid surface.

⚠ Burn hazard



Before moving the machine, the water reservoir must be empty and the boiler must be fully cooled down.

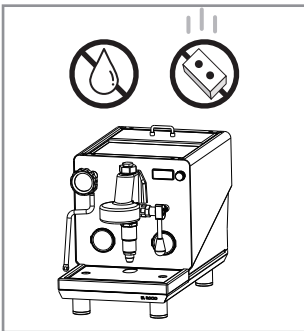

- Do not place liquids such as water or milk on top of the cup warmer, and keep falling objects away from the machine.
- Do not use with a piece of cloth covering the machine.
- Keep out of children's reach and make sure children do not use the machine.

Precautions

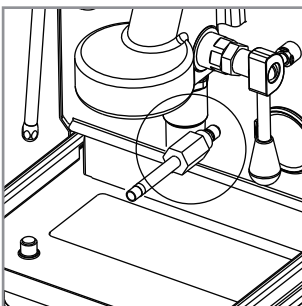
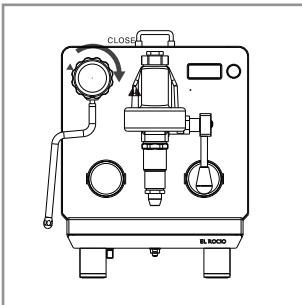
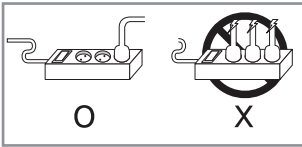

- A safety-approved unit must be used when using a multi-tab power strip.
This unit requires 10A+ (1.5Kw) electric current to operate.
※ using too many plugs at once can lead to a power overload fire.
- Do not place sharp objects or flammable, combustible liquids that can cause electrocution around the machine.
- Keep the machine away from heat sources or other electronics.
- The risk of electrocution exists when touching the machine with wet hands.
- Do not pull or crush the power cord. (Cannot swap the power cord)
- This product requires a ground connection. Without a ground connection, there is a risk of product damage, electrocution, or short circuit in case of a thunder strike.
- Close the steam valve clockwise until completely closed before using.
- If standby time gets excessively long after being fully preheated, the extraction valve internals turn into a vacuum state and can interfere with normal machine operations.
- If not using the machine for a long time, please keep the machine powered off and follow the long-term storage instructions on page 15.
- The group head is extremely hot after being preheated. Please avoid burn damage by not touching the group head.

Burn hazard



Hot surfaces. Do not touch.
Proceed with caution when using.

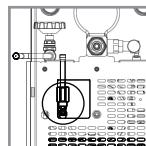

Ball valve opened (when parallel to the group head)

The water inside can be disposed of by opening the ball valve located at the bottom left side of the front panel.

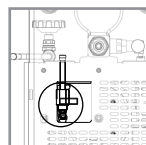

Ball valve closed (when perpendicular to the group head)

When using the machine, the ball valve must be fully closed/shut by being perpendicular to the group head

***Safety accident hazard when not fully closed/shut.**

Information display

When on, the Manus machine's status can be checked on the temperature display.



• temperature display

check Displays current steam temperature, Please set the steam temperature in the settings menu according to the desired steam pressure.

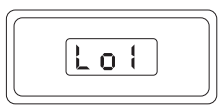

• No water in water reservoir

check This message appears when there is no water in water reservoir. Please fill water reservoir with water. When filling water reservoir, it must be removed from the machine.



• No water in boiler

check This message appears when there is no water in the boiler. When water reservoir is filled and machine is turned on, the boiler will start to get filled with water.

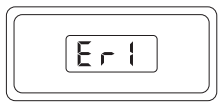

• When PID cannot be controlled

check Please turn the machine on, allow machine to fully cool down, then turn it on again. If same message appears repetitively after performing the step above, contact customer service.

User Instructions

The recommended single extraction time is a maximum of 30 seconds, and we recommend 1 1-minute rest time after every use.

* 30-second extraction / 1-minute rest (based on 2 shot lungo, 80ml extraction)

1. Water reservoir removal and water refill

Before connecting to power, remove the water tank in the order of the diagrams below and fill the water reservoir with water.

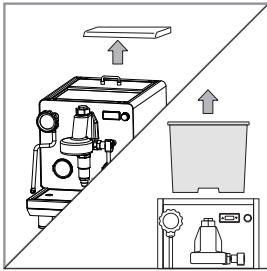

- 1) Open the top water reservoir cover and remove the water reservoir by pulling it upwards.

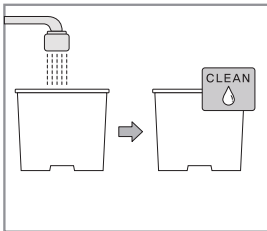

- 2) Clean the water reservoir and remove outer moisture

check

We recommend drying after cleaning

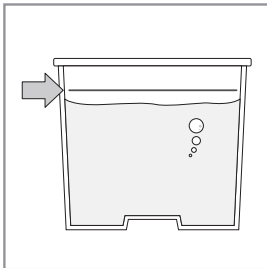

- 3) After cleaning, fill the reservoir with water up to the guide line

check

When using a home water purifier, please check the filter replacement period before filling with water



WARNING

When removing the water reservoir or filling water reservoir with water, please make sure the machine's power is off. It may cause machine malfunction.

User Instructions

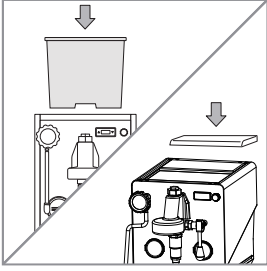

1) Please check the direction of the water reservoir.

* The water level sensor must be on the left side for the water level detection function to operate properly.

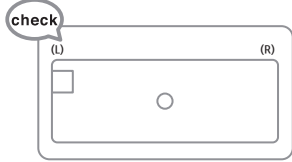

check
Check for foreign objects in the water reservoir.

* Filling the boiler up to its appropriate water level requires a lot of water. Please make sure water is filled up to the guide line on first use.

2. Turning the machine on and preheating

1. Check the precautions and connect the power plug to the outlet.
 2. Turn on the machine by pushing up the power switch on the right side of the front panel.
 3. When turning the machine on for the first time, the pump will operate and the boiler will get filled up with water from the water reservoir.
 4. Wait to preheat until the temperature is up to the set temperature on the right-side temperature display.
- * For steam, preheat is complete when pressure reads 1-1.5bar

check
Connect only after reading the precautions
Check the steam knob being fully closed by turning clockwise before turning the machine on.

3. Using steam

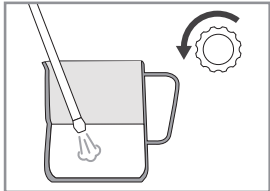

1) Place the steam wand inside of a steam pitcher with milk inside, turn the steam knob counterclockwise, and begin steaming milk.

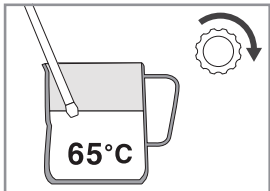

2) When the milk reaches the appropriate temperature, turn the steam knob clockwise to a completely locked position.

check
WARNING
Burn Hazard

- The steam wand will get very hot after using the steam function for an extended time. Please be cautious of the steam wand becoming a burn hazard.
- When releasing condensate, please turn the nozzle over to the drip tray and use a wet towel to cover the nozzle before releasing
- Directly touching steam that's being released is a burn hazard it.

How to use

4. Extraction

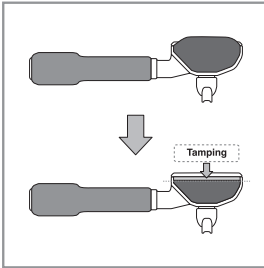

- 1) Dose an adequate amount of coffee into the portafilter basket, and tamp using a tamper.

check

When tamping, make sure the portafilter is in a secure position and avoid wrist injuries by not applying excessive pressure.

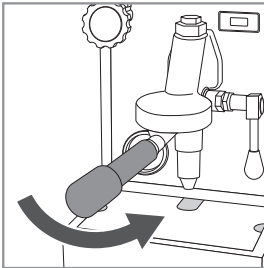

- 2) Lock in the portafilter from the 8 o'clock position to 6 o'clock position

1. When locking the portafilter in, ensure it is level. Both wings of the portafilter must be fully inside the group head before locking in.
2. Before locking the portafilter in, we recommend a 3-4 second flushing of the group by turning the brew group lever up.

check



When locking in the portafilter, pay extra attention to the group head as it is a burn hazard.

* brew water and group head temperature ranges from 85-99°C which are high temperatures.

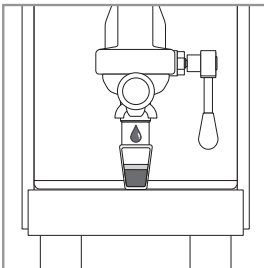

- 3) Begin extraction by flipping the brew group lever upwards until the desired output is reached.

check

Overly forced portafilter lock-in and removing the portafilter mid-extraction can cause damage to the machine and can cause bodily injuries from high temperature and high pressure

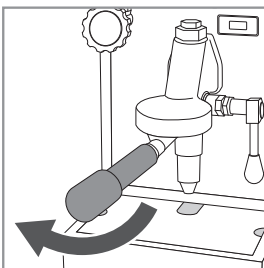

- 4) Remove the portafilter after extraction is finished by turning the portafilter handle from 7 o'clock to 6 o'clock position

How to use

Change modes by turning the dial knob, and select modes by pushing the dial knob in.



turning the dial knob click



- Push and hold for 3 seconds to enter settings.
When HoE is selected, the machine goes from settings to regular mode.



- Set boiler temperature.

check min 60°C ~ Max 130°C

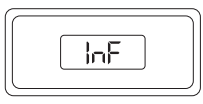

- Set pre-infusion duration.

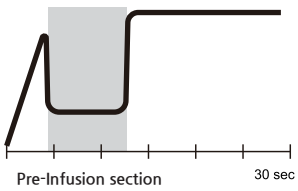

check min 4sec ~ max 10sec



- Set standby time until the machine goes into eco mode.

check 45 = 45min, 1H = 1hour, 2H = 2hour
When the dial is pushed and held for 3 seconds here, it will automatically go into eco mode.



- From 5-10, select extraction pressure (flow rate).

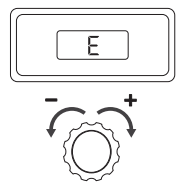
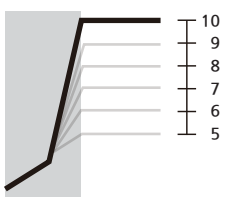

check 5= pump output 50%,
10= pump output 100%

check E mode: starts extraction at the lowest flow rate, and extraction pressure can be manually controlled by turning the dial left to decrease pressure and right to increase pressure.

Cleaning and maintenance

How to install and remove shower screen

- 1) Place the shower screen and gasket on top of the portafilter without the basket.

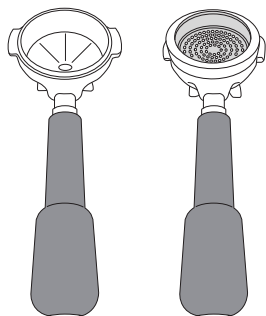

- 2) Take the prepared portafilter with shower screen and gasket, place it into the group head, and turn as far counterclockwise as the portafilter can go to install the shower screen.

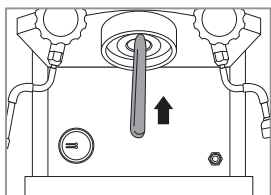
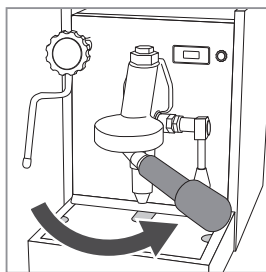
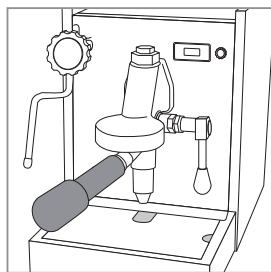

check

When the gasket does not fit properly, use a blunt tool to push it upwards

Cleaning and maintenance

3) Check for correct installation by placing a basket inside the portafilter and attaching the portafilter to the group head.

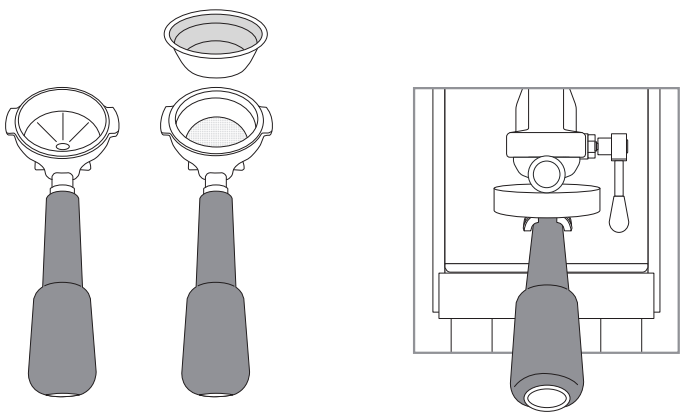

4) How to remove the shower screen

Take a tool without a sharp end (teaspoon, etc) and pull it down at the edge of the shower screen.

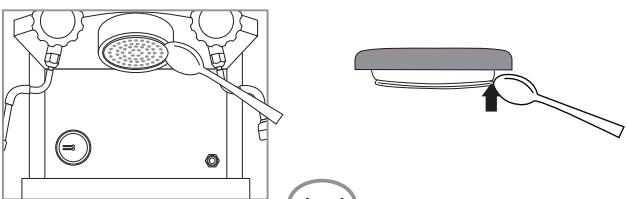

check

The rounded side goes in towards the group head internals, and the flat side faces the bottom. Please ensure the correct direction when installing.

Cleaning and maintenance

- ※ Please ensure the machine is fully off and cooled off with the main switch in the off position before cleaning the machine.

1. Cleaning the group head

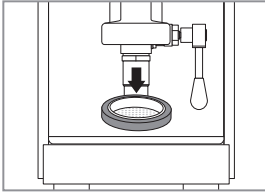

- 1) Remove the shower screen from the group head as shown in the diagram.

- ※ Use a tool to remove the shower screen and be careful not to scratch or damage the group head.

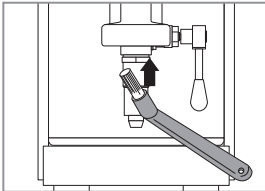

- 2) Clean with a cleaning brush.

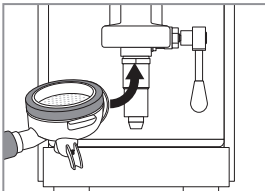

- 3) After cleaning, use the portafilter to re-install the shower screen.



CAUTION
Burn Hazard

check

Do not use your hand to remove the shower screen from the group head. Use a tool to remove the shower screen.

2. Cleaning the steam wand

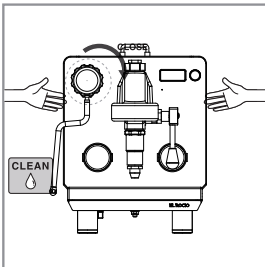

- Hold the steam wand and keep it stationary while using a wet towel or similar to wipe off any residue.



CAUTION
Burn Hazard

check

Only clean when the steam/hot water knobs are fully closed

- ※ After usage, the machine power must be off to prevent burns or second physical damage.

Cleaning and maintenance

3. Cleaning water tank

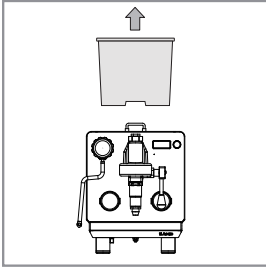

1) Remove water tank from the machine.

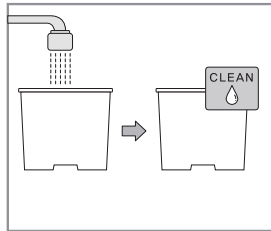

2) Wash and clean the water reservoir well.

3) Fully remove moisture and install water reservoir the opposite order of removal.

4. Cleaning drip tray

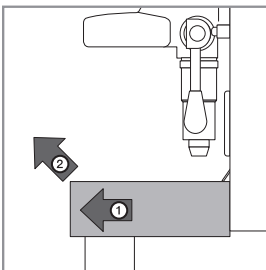

1) Take both hands to grip the ends of drip tray then slowly pull the drip tray forwards away from machine.

2) Keep pulling the drip tray until completely removed.

3) After removing and cleaning, install the opposite order of removal.

check

Do not pull with excessive force. Leftover water may splash out and cause an accident. Remove with caution.

Long-term storage tips - How to remove water from the boiler

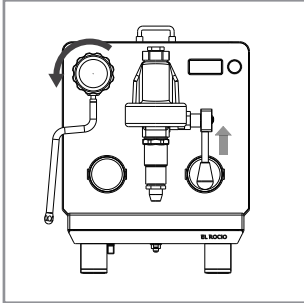

1. Preheat well for over 30 minutes, turn off the machine, and turn the brew lever upto remove any water left in the heat exchange chamber

2. Open the steam valve fully for over 10 minutes until any leftover boiler pressure is fully removed.

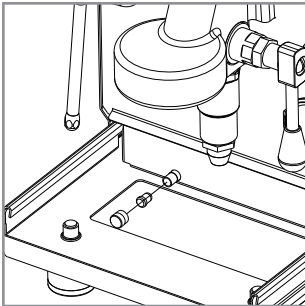

3. After checking the water inside boiler being fully cooled down, open the drain cap and open the inner cover.

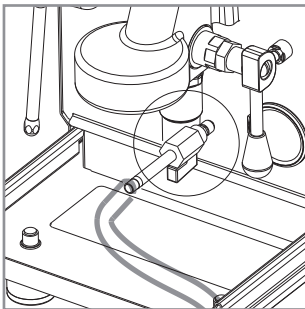

4. Connect and position the included drain hose to safely remove drain water

5. Open the ball valve as shown in the diagram to drain all water inside the boiler, then close the cover and cap

*During long-term storage, it is fine to keep the ball valve/steam valve open but when re-operating the machine, the ball valve and steam valve must be fully closed

FAQ

Q . Temperature is not showing on display and instead, Lo1 appears.

A . Fill water in the water tank.

Q . When first plugged in, the machine makes noise.

A . The noise is from the pump working to fill the boiler with water.

Please check to see if there is water in the water tank.

Q . Water leaks out of the portafilter during extraction.

A . There may be too much coffee or the portafilter may not be fully attached to the group head.

Please tamp after dosing coffee up to the basket line and attach portafilter into grouphead fully until the portafilter can no longer move.

Q . Group head only produces steam after idling after having been preheated.

A . Because this is an HX heat exchange machine, when the machine idles for too long after being preheated, the extraction tube will only have steam inside. In this case, allow machine to completely cool down and then use it again.

Q . Machine was used without any water in the water tank. What now?

A . If the machine was operated for a long time without water, then air will have entered the inner tubes of the machine and will not work but once the water tank is inserted 5-6 times repeatedly or the machine is cooled down properly, the machine will function normally.

Q . Brew temperature is set to 93°C and there is no steam.

A . Steam is produced at over 100°C. Please set the temperature to over 100°C to use steam.

Q . How do I descale the machine (including mushroom/jiggler)?

A . Because there are many descaling solutions and there are risks of damage from user know-how, we do not recommend self-descaling. For more information, please call us.

Q . When preheating, the machine makes a bubbling noise.

A.It is the vacuum valve (vacuum-preventing tool) functioning. It is a safety tool, so please use it without worry.

check

**Every heating element is composed of over 3 different safety mechanisms and tools.
Use without worry!**

Some consumable parts must be replaced regularly throughout use.
(consumable parts: gasket, screen, basket, block spring, hot water, and steam nozzle rubber ring)



Please check when machine is received.

A/S Guideline

A/S is conducted via shipping the machine to the manufacturer, so please keep the box the machine was shipped in.

*When booking on-site service or requesting shipment boxes, additional charges may occur.

Notice

Protection film may have air bubbles because El rocio products are handcrafted.

All El Rocio products go under quality control protocols even right before the machines are shipped. Therefore, some moisture may be on the machines upon arrival

COMPANY INFO

FLOWELL CO., LTD.

Address : 70-23 Yuram-gil 95beon-gil, Paltan-myeon,
flowell, Hwaseong 18530

Tel : +82 70-4618-4321

E-mail : elrocio2013@naver.com

www.elrocio.co.kr

MEMO

